

TRACE
KD Desk
Hutch

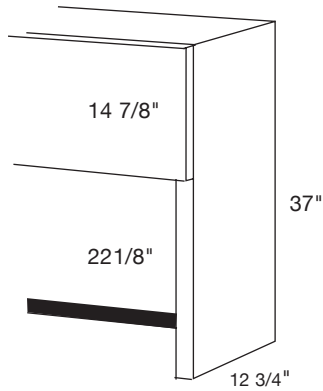

Our Hutch helps you to maximize storage and working space while providing separation in open office spaces. Overhead locking compartments keep your work essentials safely tucked away and within easy reach. Two doors slide neatly above the top for full access to interior compartments. When adding task lighting, wiring can be channeled through removable side panels. A tack board provides an opportunity for a pop of color and a place to pin daily reminders.

KD Desk Hutch



BASIC CONSTRUCTION

- Doors flip up to stow over the top, hutch compartment includes a vertical center divider
- 36" and 42" wide hutches include one door, all others include two doors
- Inside depth is 12-1/2" and inside height is 12-1/4"
- Out-of-sight locks are located beneath shelf, and the two doors are keyed alike
- Includes UM series locks - also available in LL. SL locks are not available
- Includes tack board and rubber wire management strip
- Bottom shelf accommodates a task light (sold separately)
- To add a loop pull (S: Satin Nickel Loop) to hutch doors, add an "L" as a suffix to the product number (no up-charge)
- Removable metal wire management covers on hutch side panels conceal task light cord
- Hutch upright side panels must be placed within 2" of a pedestal, panel leg, or corner leg to ensure adequate support
- Hutch width is actually 1" narrower than listed, to allow for 1/2" setback on both sides
- Hutch ships knocked down with assembly instructions for field installation
- Specify metal color and fabric
- For yardage requirements see "Ordering COM Fabrics" in this price book

REQUIRED FOR 54" OR 66" FABRIC

- 36" wide tack board requires 42" fabric (1-1/2 linear yard)
- 42" wide tack board requires 48" fabric (1-1/2 linear yards)
- 48" wide tack board requires 54" fabric (1-1/2 linear yards)
- 54" wide tack board requires 66" fabric (2 linear yards)
- 60" wide tack board requires 66" fabric (2 linear yards)
- 66" wide tack board requires 72" fabric (2 linear yards)
- 72" wide tack board requires 77" fabric (2-1/2 linear yards)

ORDERING GUIDE

H	D	W	Pkg Wt	Pkg Cube	Part #	Metal Color	Fabric #	GR 1 Price	GR 2 Price	GR 3 Price	GR 4 Price	GR 5 Price	COM Price
37	13-5/8	36	60 lb	13.3 ft	HGC 3602	?	?	\$2,871	\$3,020	\$3,127	\$3,236	\$3,324	\$2,864
37	13-5/8	42	66 lb	15.4 ft	HGC 4202	?	?	\$3,079	\$3,083	\$3,190	\$3,298	\$3,387	\$3,074
37	13-5/8	48	75 lb	17.5 ft	HGC 4802	?	?	\$3,144	\$3,145	\$3,252	\$3,360	\$3,446	\$3,137
37	13-5/8	54	81 lb	19.6 ft	HGC 5402	?	?	\$3,219	\$3,300	\$3,445	\$3,589	\$3,705	\$3,214
37	13-5/8	60	87 lb	21.7 ft	HGC 6002	?	?	\$3,288	\$3,361	\$3,507	\$3,649	\$3,767	\$3,281
37	13-5/8	66	93 lb	23.8 ft	HGC 6602	?	?	\$3,352	\$3,421	\$3,566	\$3,709	\$3,828	\$3,347
37	13-5/8	72	99 lb	25.9 ft	HGC 7202	?	?	\$3,447	\$3,602	\$3,780	\$3,960	\$4,107	\$3,442

