

## INSTALLING FILLS WITH WOODEN CLEATS

### TOOLS NEEDED:

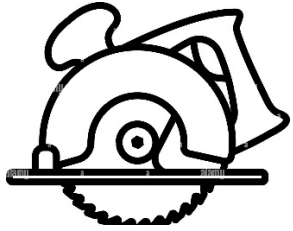

POWER SAW



POWER DRILL

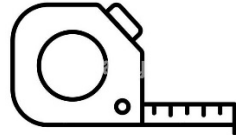

TAPE MEASURE



SCREW DRIVERS



SPRAY ADHESIVE  
(SPRAY GLUE & CHISEL IF INSTALLING EDGE BAND)



CHISEL

### INSTALL WITH CABINETS

- Measure opening to fill.
- Cut fill to size & dry fit.
- Align cleat to side of fill, making sure there is no overlap of cleat past the edge of the fill, and screw through cleat into fill in multiple spots. Do not overtighten screws.
- Align fill to side of cabinet so it is flush with the front of the cabinet end panel, and screw through cleat into cabinet side. Do not overtighten.
- Be sure screws do not hit each other or damage opposite side of fill or side panel.
- Fit cabinet into place.

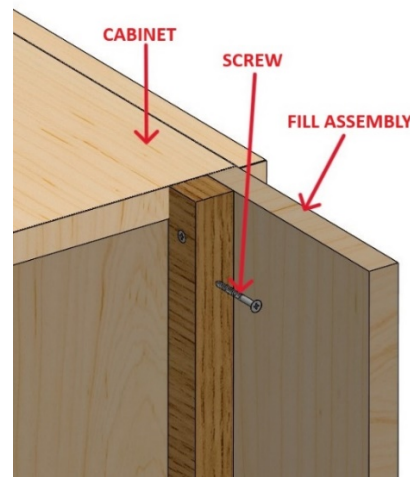
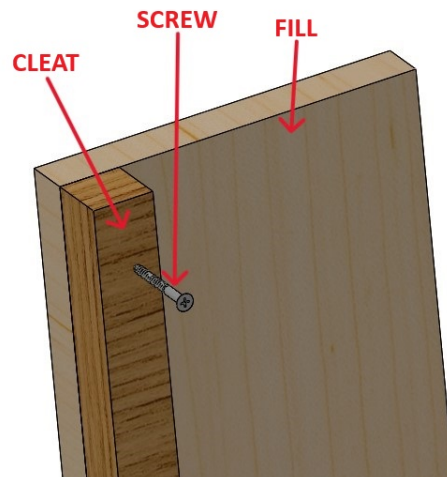

## INSTALL AFTER CABINETS

- Measure opening to fill.
- Cut fill to size & dry fit.
- Align cleat to side of fill, making sure there is no overlap of cleat past the edge of the fill, and screw through cleat into fill in multiple spots.
- Align fill to side of cabinet so it is flush with the front of the cabinet end panel.
- Screw from inside of cabinet through end panel and into the center of the cleat, roughly 1.25" back from the front of the cabinet end panel. Do not overtighten screws.
- Be sure screws do not hit each other or damage opposite side of fill.

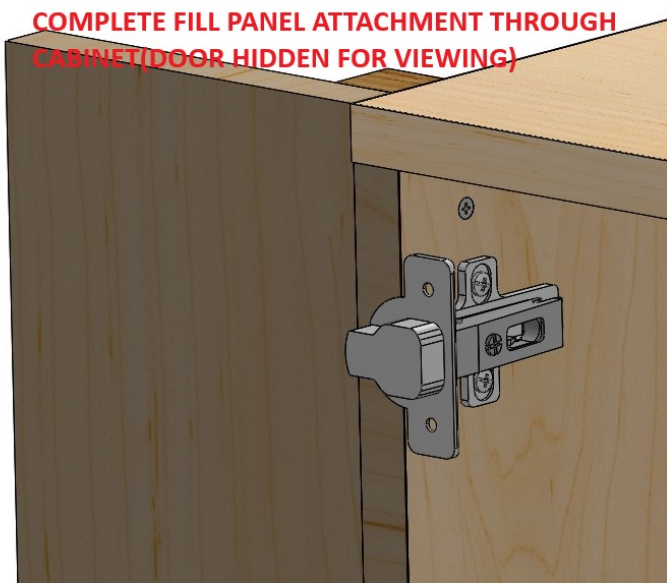
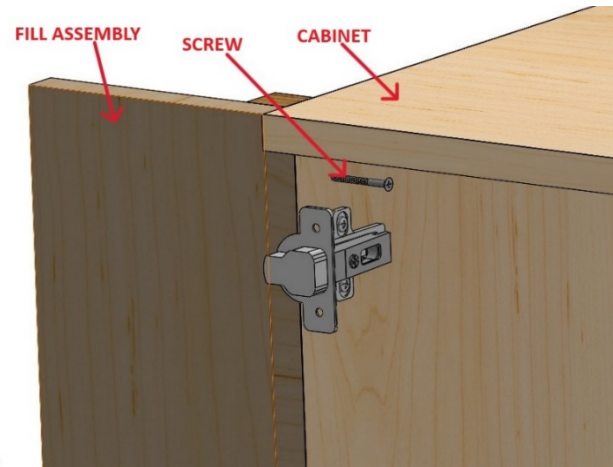
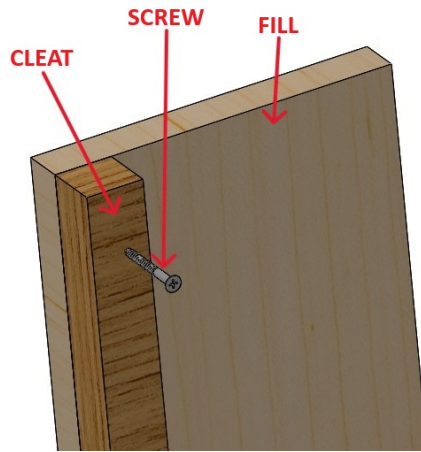

## INSTALL CORNER FILLS

- Measure opening to fill – be sure to allow plenty of room for door/drawer movement.
- Cut fill to size & dry fit – one panel should overlap the other for attachment.
- Align fill panels so one overlaps the other and screw through that one and into the other to secure. Do not overtighten.
- Align cleats to side of fills, making sure there is no overlap of cleat past the edge of the fill, and screw through cleat into fill in multiple spots (do for both filler panels). Do not overtighten screws.
- Align corner fills to side of cabinets, flush to the front of the end panels.
- Screw from inside of cabinet through end panel and into the center of the cleats, roughly 1.25" back from the front of the cabinet end panel.
- Be sure screws do not hit each other or damage opposite side of fill.

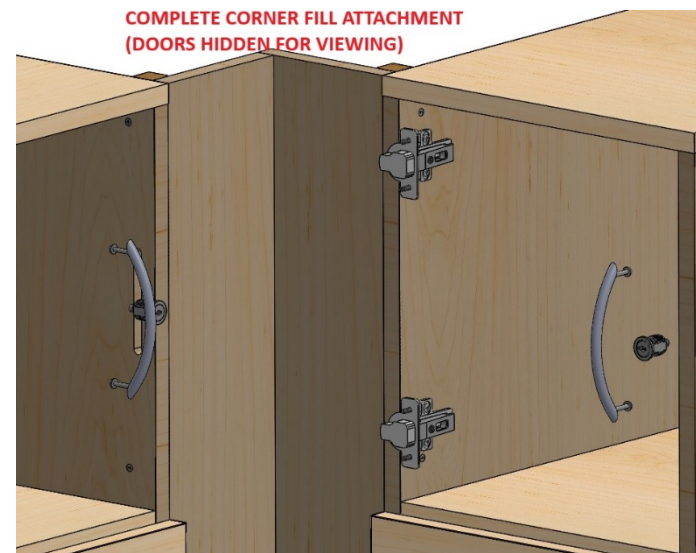
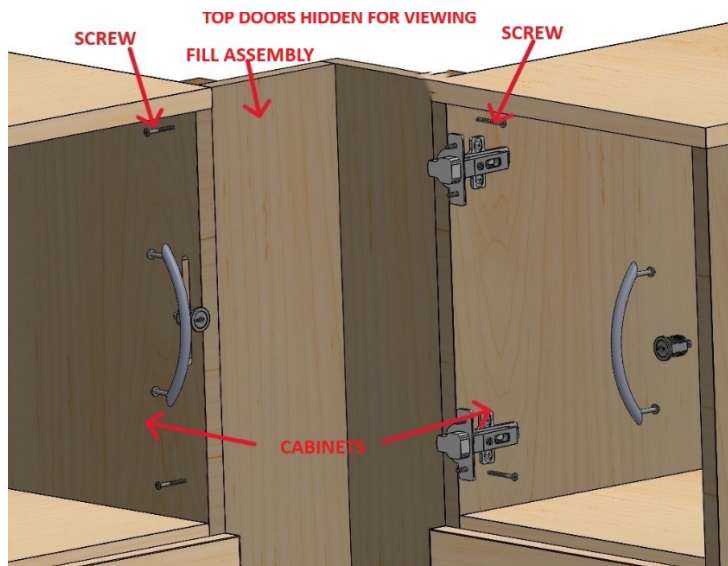
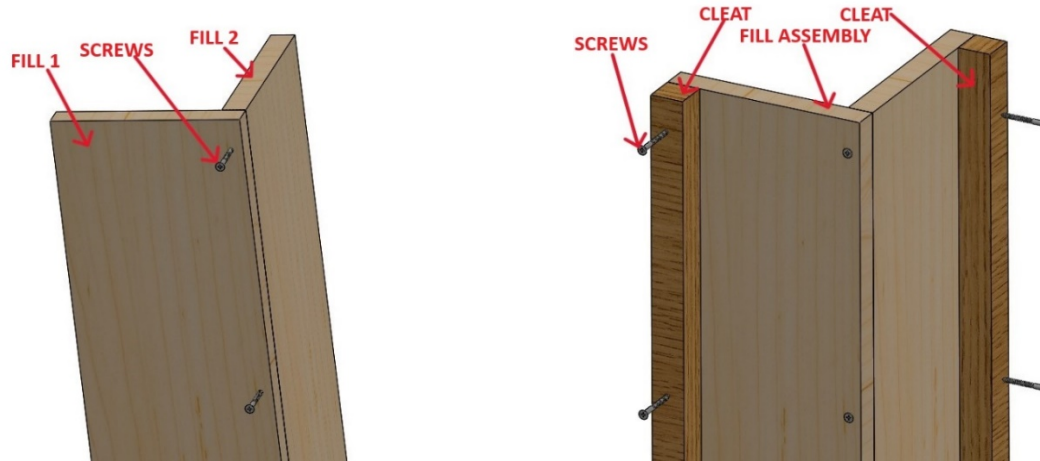

## INSTALL TOP FILLS

- Measure opening to fill – measure gap between side wall & cabinet, then back wall to front where fill is to line up (overall depth of top filler needed).
- Cut fill to size & dry fit – if edge band is needed, see instructions to add below to add to the visible edges of top fill.
- Attach a cleat to side of cabinet with screws, do not overtighten. Cleat should be below the cabinet top surface the thickness of the top filler panel. Make sure cleat is level with cabinet top as this is where the top fill will sit.
- Cabinet mounted cleat can also be screwed in from inside of the cabinet if needed in tight spaces. You may want to predrill the screw holes in the cabinet side to ease assembly if done this way.
- Attach a cleat to wall with screws, do not overtighten. Find wall studs to mount to or use anchors. Cleat should be below the cabinet top surface the thickness of the top filler panel, or parallel with the cleat on the cabinet. Make sure cleat is level as this is where the top fill will sit.
- Test fit top fill panel on the cleats. If you are happy with the results, add adhesive between the cleats and the top fill to secure it in place. If not, make adjustments to the cleat alignment until you get the placement you want with the top fill, then adhere.

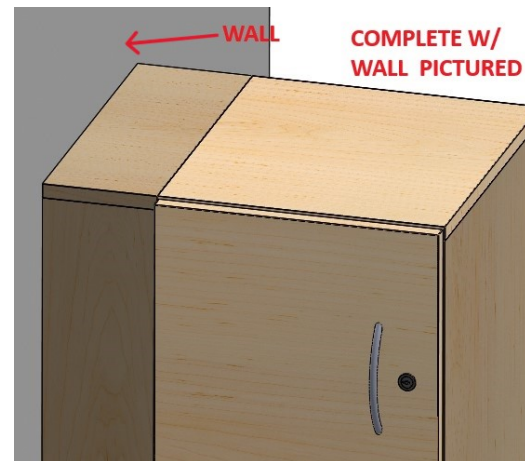
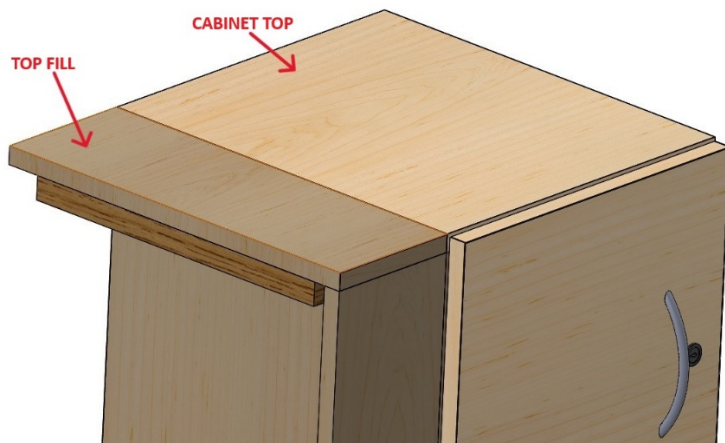
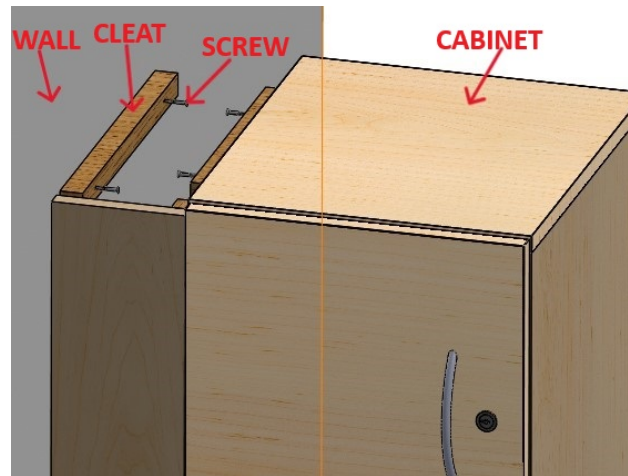
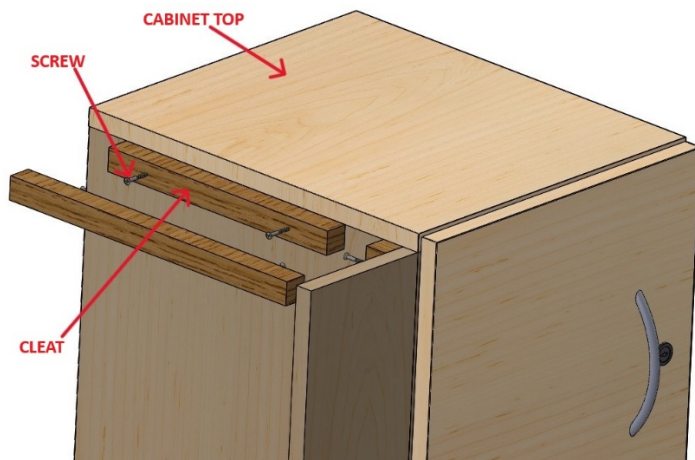

## INSTALL EDGE TO FILLS (IF APPLICABLE)

- Measure length of panel edge to cover with edge band.
- Cut length of edge band longer than previous measurement so there is overhang to work with, minimum of 1" overhang.
- Use spray contact adhesive and cover both inner face of edge band and the face edge of panel to cover. Allow to almost dry according to instructions on the adhesive.
- Carefully place edge band onto panel edge leaving overhang all around. Press firmly to get good adhesion to the panel.
- Using a sharp chisel, utility knife, or router, carefully trim the pvc edge to be flush with the wood panel. Keep blade flat to laminate surface so as to not gouge or cut the laminate finish.
- Clean surface of any excess adhesive with solvent recommended on the adhesive product.

